

LifeSmart

Smart Switch Air

INSTRUCTION

The LifeSmart Smart Switch Air series replace your traditional switch with CoSS protocol to make your life easier. Combined with the LifeSmart Smart Station and the free LifeSmart App, you have infinite control possibilities.

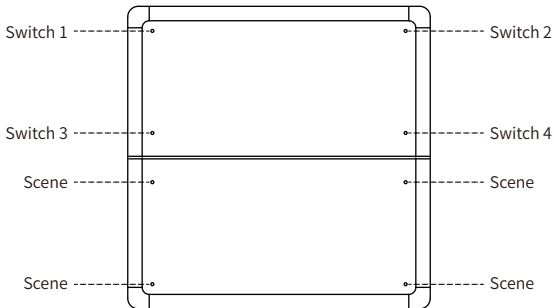

The function of each button can be customized through App, and the number of the switch ways subject to actual purchase.

SPECIFICATIONS

Size	Overall: 86*86*34mm Outside the wall: 86*86*8mm
Input	AC 110-240V~ 50/60Hz
Maximum load	Resistive load: 500W/channel Inductive/capacitive load: 200W/channel Sum current of each channel <10A Scene Panel does not support load
Wireless protocol	CoSS
Wireless distance	200m(open field)
Operating temperature	-5~45°C
Operating humidity	5~90%

WIRING INSTRUCTION

L: Switch-in Live Wire

L1: Switch-out Live Wire 1

L2: Switch-out Live Wire 2

L3: Switch-out Live Wire 3

L4: Switch-out Live Wire 4

N: Switch-in Neutral Wire

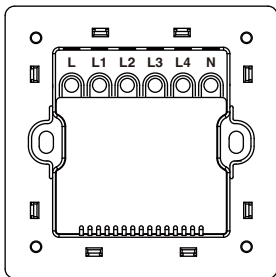

Note

The number of output lines varies according to different products, please refer to the actual product.

The installation involves high voltage and should be operated by a professional electrician.

The installation location of the panel needs to have a neutral wire; when the environment has more than one neutral circuit, it is necessary to ensure that it is in the same neutral circuit with the controlled lights.

Please strictly observe the load power limits and control the number of appliances per circuit to no more than 4.

INSTALLATION

1. Cut off the electrical power supply and make sure the wiring is not charged. Then connect the wires according to the wiring instruction, make sure all the wires are placed firmly.
2. Lift all keypads with your fingers.
3. Place the wires in the cassette orderly, and fix the switch to the cassette with fixing screws.
4. Simply install the keypads back.
5. Restore the power supply, the device will turn on automatically.
6. After configuration of the Smart Station, choose "Add Device" in LifeSmart App, select "Smart Switch Air". Follow the instruction on the app to finish pairing.
7. Long press the Switch 1 button (the upper left corner of the switch) then the indicator will start to flash slowly, which indicates that the device is ready to pairing.

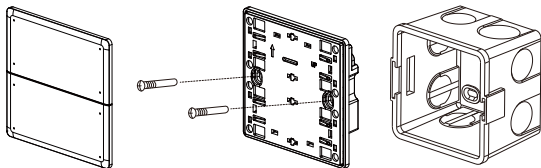

*Cassette need to be provided by yourself

WARRANTY DESCRIPTION

Thank you for purchasing this LifeSmart product. In order to protect your rights, please read the following content carefully: The warranty period of our company's products is one year from the date of purchase or longer if local laws impose a longer minimum term, in which case the minimum term is the warranty period. During the warranty period, any faults caused by the product itself or for quality problems that arise under normal usage, LifeSmart will provide a free replacement.

User support e-mail address

support@ilifsmart.com

Website

iot.ilifsmart.com



Manufacturer: HANGZHOU LIFESMART TECHNOLOGY CO.,LTD.

Address: 22th Floor, Yuesheng International Center, 518 Pinglan Road, Xiaoshan District, Hangzhou, Zhejiang, China

ATTENTION

The following conditions are not covered by the warranty:

- Product failure or damage caused by installation, use, and maintenance that is not in accordance with the product instructions;
- Products beyond the warranty period;
- Products that have the barcode tampered with or removed;
- Devices that have been tampered with or customized outside of LifeSmart Terms Of Service as on the LifeSmart APP and website;
- User-caused damage, such as inappropriate voltage input, high temperature, accidental spillage, physical damage, etc;
- Product failure or damage caused by force majeure such as earthquakes, fires, or floods;
- Product failure or damage caused by other problems except the product itself.

DECLARATION

DECLARATION OF CONFORMITY

Hereby, LifeSmart declares that the radio equipment type is in compliance with Directive 2014/53/EU. The full text of the EU declaration of conformity is available at the following internet address:

<http://global.ilifsmart.com/ce/docs/>



Notice: This device may be used in each member state in EU.

DISPOSAL AND RECYCLE INFORMATION

Device labelled with this symbol should not be disposed with other household wastes. It shall be handed over to the applicable collection point for the recycling of waste electrical and electronic equipment.



 Facebook: ilifsmarthome

 Twitter: ilifsmarthome

Copyright © 2024 LifeSmart Inc. All Rights Reserved.