

Smart Door Lock C200

Product Manual

V1.0

Please read this manual carefully before using the product and keep it properly.

Packing list

①Front panel ②Back panel ③Mechanical lock body ④Accessories package ⑤Door key cylinder package
⑥AA Battery x4 ⑦Installation hole diagram ⑧Installing lining plate ⑨instructions ⑩NFC card x2

Product introduction

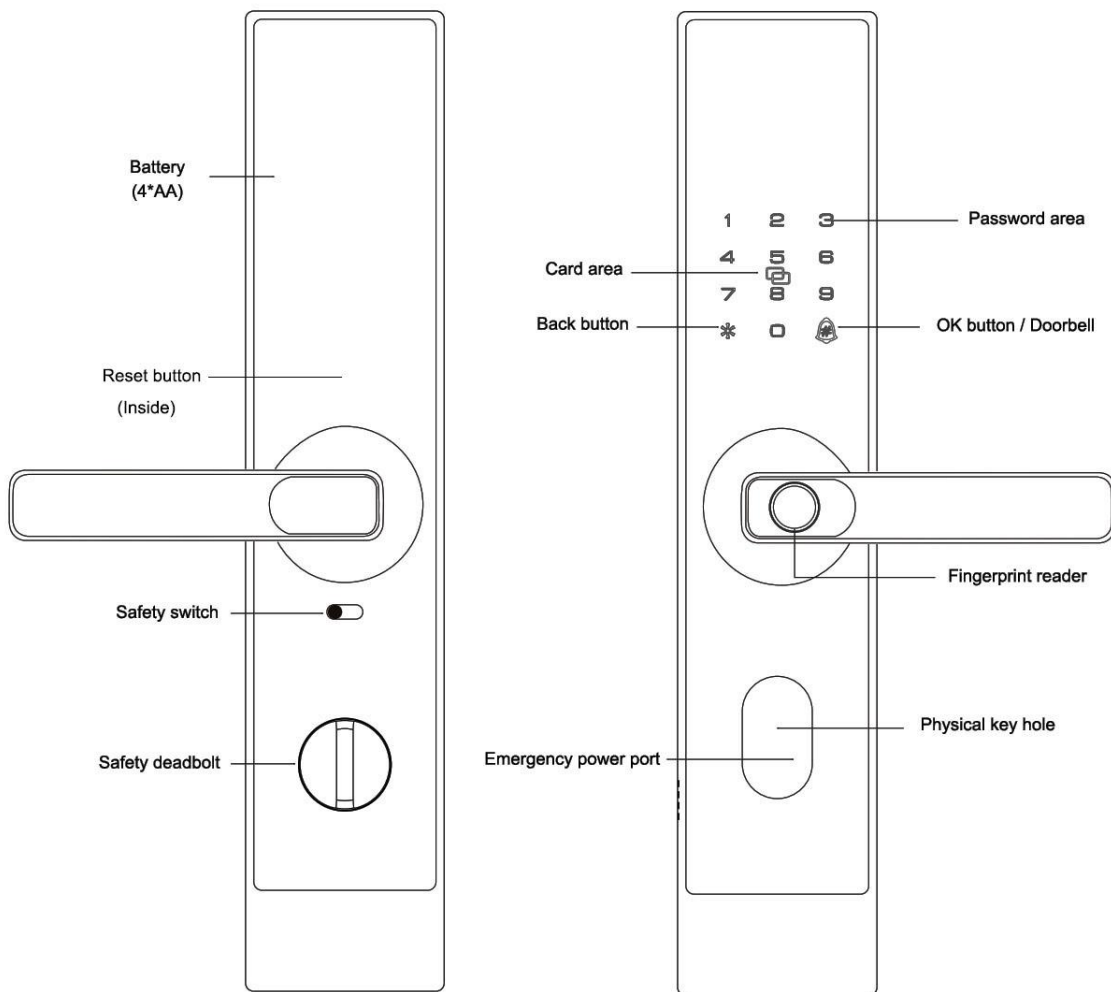

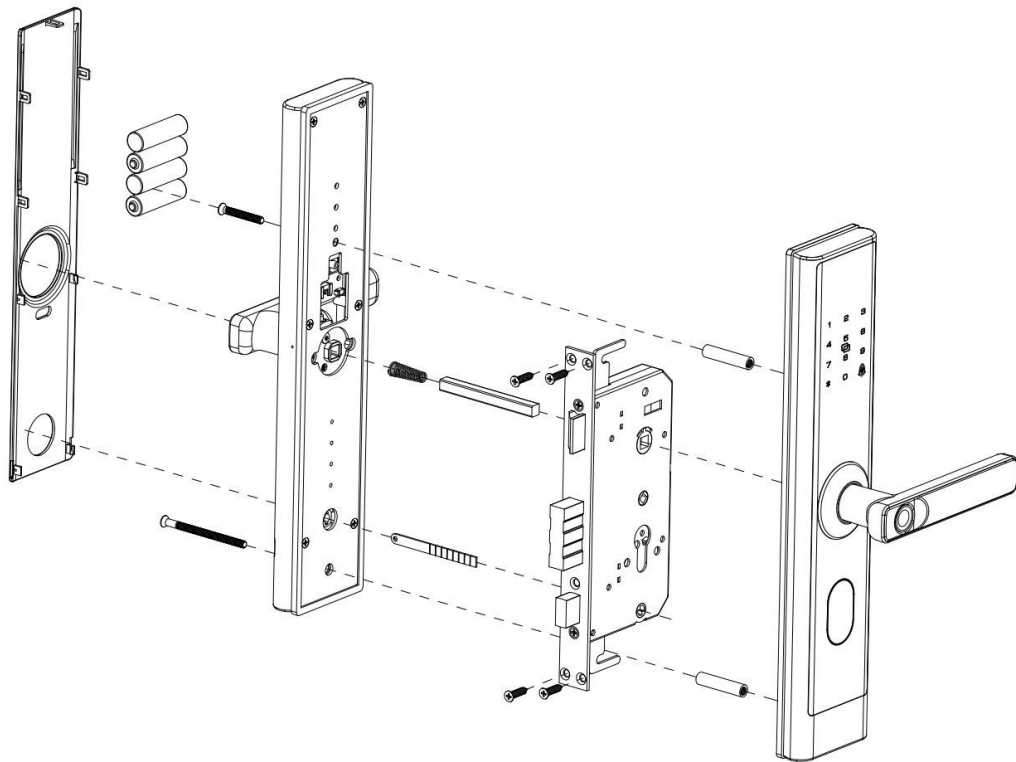

Smart door lock installation

The installation process of smart door locks typically involves the use of specialized tools and equipment. Therefore, it is highly advisable to have trained professionals handle the installation.



Please scan the QR code on the right side for installation guidance videos.

Smart door lock usage

After the door lock is installed, please open the back cover of the inner lock and insert 4 AA dry batteries;

1. First-time use

1.1 First-time use: administrator settings are required, and one or more of fingerprints and passwords are set as passwords.

1.2 Subsequent management: Enter "*"#" to enter the setting page. After verifying the identity of the administrator, you can set the management user settings and ordinary user settings.

1.3 The operation menu is as follows:

Press 1 to enter admin user settings:

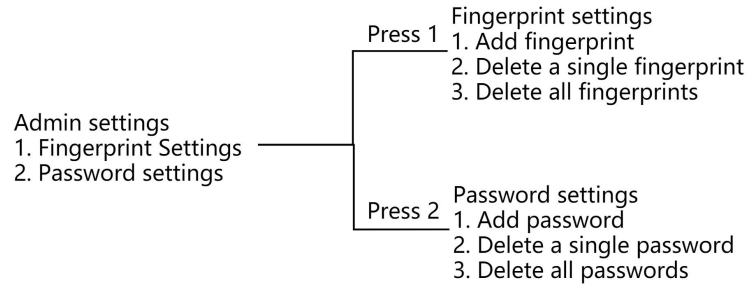

Press 2 to enter Normal user settings:

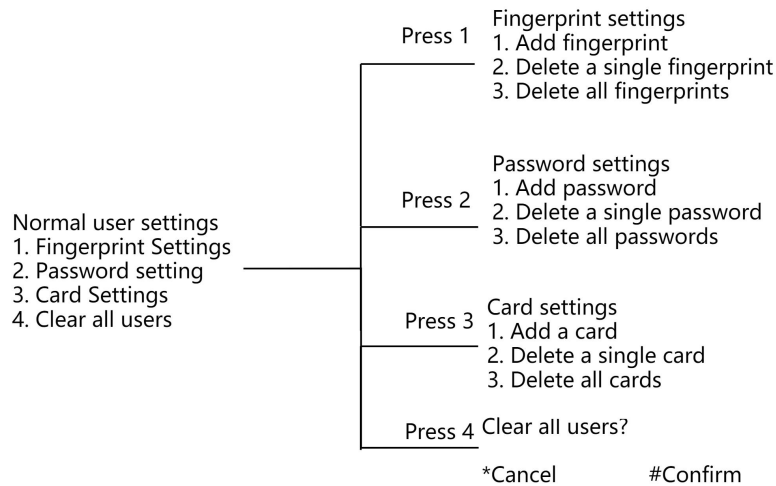

Press 3 to enter the system settings: if you need device binding operation, press 1 to bind the operation, after the binding result is returned, the voice prompt "Start binding", and then the APP can perform the pairing operation; If you need to unbind the device, press 2 to unbind the device.

Press 4 to enter the volume setting: press 1 to set the doorbell volume, and press 2 to set the system volume; You can set the high, medium and low volume according to actual needs.

Press 5 to enter the language switch: Press 1 to set Chinese and press 2 to set English.

For more operations, please refer to the actual broadcast menu of the door lock. After completing the settings, please download the APP as soon as possible to use more and more comprehensive functions.

2. Restore factory settings

If you forget the password, you can open the back cover of the inner lock, reset the button by needle poke for 5 seconds, press the "#" key to confirm according to the voice prompt, and then perform a factory reset.

3. Daily use

3.1 Daily use: directly use one of the set fingerprint, password and card to verify and open the door.

3.2 Temporary password to open the door: enter 9# to start the temporary password service, then enter the temporary password, press # key to confirm; 9# can be preceded by a password with up to 4 virtual digits. For example: enter "XXXX9#12345678#" to open the door, where 12345678 is a temporary password string and

XXXX is any number, which can be added or not.

3.3 Emergency power supply: If the door lock is completely powered off, you can use a mobile power source such as a charging treasure, and after supplying power through the emergency power supply port, use your fingerprint, password, or card to open the door. After the door is successfully opened, please replace the battery as soon as possible.

3.4 Forced demolition alarm: When the lock is forcibly removed, the lock will sound an alarm for 60 seconds.

3.5 System lock: within 5 minutes, the password and card verification fails for 3 consecutive times, and the fingerprint verification fails for 5 consecutive times, and the system is locked for 3 minutes. In this case, it is necessary to wait for the lockout to end and perform authentication again.

3.6 Low battery warning: When the battery is low, it is recommended to use it after replacing the battery.

App instructions

1. Download App

Our Smart Door Lock requires the LifeSmart App and Smart Station to operate. Please download the App to your smart devices. The App is available by scanning the following QR Code, or go to the Google Play Store or iOS App Store directly.

www.ilifsmart.com/getapp_gp.html



LifeSmart App

2. Paired with Smart Station

Open the APP homepage and first add a good wisdom center; Select "Add New Device", select the door lock device C200, select the smart center you need to join, and enter the pairing link. According to the APP prompt, initiate a device binding request on the door lock to complete the pairing, if the pairing is unsuccessful, please pair again. Due to the upgrade and update of the APP, the actual operation may be slightly different from the above description, please follow the instructions in the current APP.

Warning function

1. Forced dismantling alarm: When the lock is forcibly dismantled, the lock will sound an alarm for 60 seconds.

2. System locking: Within 5 minutes, the password and card have failed verification three times in a row, the fingerprint has failed verification five times in a row, and the system has been locked for 3 minutes.

3. Low battery alarm: When the battery is low, every time the door is opened, a low battery voice is broadcast.

Basic parameters

Product model: C200

Product size: 360*73*23mm

Power supply mode: 4 AA dry batteries, Type-C emergency power supply

Wireless protocol: COSS

Executive standard: GA 374-2019

Working humidity: <93%

Working temperature: -25° C~70° C

Instructions for using micro power devices

1. The NFC technology used in this product complies with the technical requirements of Class C equipment in the "Catalogue and Technical Requirements for Micropower Short Range Radio Transmitting Equipment", and is used for data transmission applications. Please refer to the relevant content in the product manual for the use of integrated antennas, control, adjustment, and switch methods;
2. Do not change the usage scenario or conditions, expand the transmission frequency range, increase the transmission power (including the installation of additional RF power amplifiers), and do not change the transmission antenna without authorization;
3. It shall not cause harmful interference to other legitimate radio stations (stations), nor shall it provide protection against harmful interference;
4. Industrial, scientific, and medical (ISM) application equipment that should withstand interference from radiated radio frequency energy or other legitimate radio station interference;
5. If harmful interference is caused to other legitimate radio stations, they should be immediately stopped from use and measures should be taken to eliminate the interference before continuing to use;
6. The use of low-power equipment in aircraft and in the electromagnetic environment protection areas of military and civilian radio stations (stations), airports, etc., such as radio observatories, meteorological radar stations, satellite earth stations (including measurement and control, ranging, reception, navigation stations) established in accordance with laws, regulations, relevant national regulations, and standards, shall comply with the regulations of electromagnetic environment protection and relevant industry authorities;
7. Prohibit the use of various model remote controls in areas with a radius of 5000 meters centered around the center point of the airport runway;
8. The operating temperature of micro power devices is -25° C to +70° C .

Warranty instructions

Thank you for purchasing this product. In order to protect your rights and interests, please read the following carefully: According to the national three guarantees policy, the warranty period of our products is one year (calculated from the date of purchase, if the date of purchase cannot be verified, the date prevails). During the warranty period, our company will provide free warranty for any faults caused by the quality problems of the product itself under normal use.

Any of the following situations does not belong to the scope of free warranty:

1. Product failure or damage caused by installation, use, maintenance, and storage not in accordance with the requirements of the instruction manual;
2. The warranty period has exceeded;
3. Unauthorized tearing and altering of product barcodes and anti-counterfeiting marks;
4. Unauthorized modification of its inherent configuration files or unauthorized disassembly and repair;
5. Product damage caused by human factors, such as inputting inappropriate voltage, high temperature, water ingress, mechanical damage, falling, severe oxidation or rust of the product, etc.
6. Damage caused by force majeure such as earthquake, flood, fire, electric shock, etc.
7. Other failures or damages caused by problems not caused by product design, technology, manufacturing, quality, etc.

Statement

Due to product version upgrades or other reasons, the contents of this manual may change. Our company reserves the right to modify the contents of this manual without any notice or hint. This manual is only used as a guide. We try our best to provide accurate information in this manual, but we do not ensure that the content of this manual is completely error-free, and all statements, information and suggestions in this manual do not constitute any express or implied guarantee.