

LifeSmart®

Simply Brilliant

Thermostatic Radiator Valve User Guide V1.0

Setting up your LifeSmart Thermostatic Radiator Valve

Model: LS197

INTRODUCTION

The LifeSmart Thermostatic Radiator Valve (TRV) senses the air temperature around them and regulates the flow of water.

Works with LifeSmart Smart Station, you can actualized independent temperature control of every single room at your home via LifeSmart app remotely, saving energy and money for you.

IN YOUR PACKAGE

Thermostatic Radiator Valve	1	User Guide	1
RA Adapter	1	RAV Adapter	1
RAVL Adapter	1	Screw Kit & Accompany Pin	1bag

SPECIFICATIONS

Size	φ55*69mm
Weight	125g
Material	ABS+PC
Sensor	NTC10K
Power supply	2 x AA alkaline batteries
Temp Accuracy	±1°C
Temperature setting range	5°C ~35°C 0.5°C/step
Thread-measure Dimension	M30 x 1.5
Adapter	RA, RAV, RAVL
Working Humidity	5~90%
Working Temperature	0~45°C
Wireless Protocol	CoSS
Wireless Distance	200m (Open field)

ILLUSTRATION

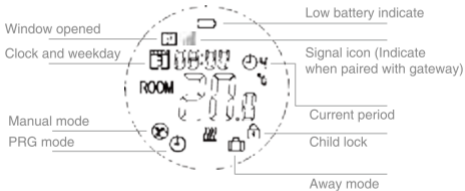

INSTALLATION

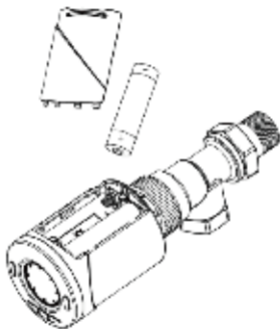

1. Once the battery installed, the TRV display **INIL**, which means initialization.

INSTALLATION

Heimeier, Junkers Landys + Gyr,
MNG, Honeywell, Braukmann
thread - measure dimension of
M 30x1.5

no adapter required

Danfoss RAV (accompanying pin
must be plugged on the valve
tapped)



Danfoss RA



Danfoss RAVL



INSTALLATION

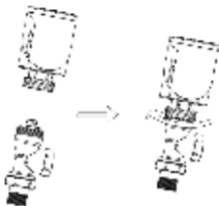

2. Install the TRV onto your radiator (take M30 adaptor as an example).
3. Then the TRV display AdAP, then press UP button (change 0 to 1), which means the TRV will adapt itself to the stroke of your valve body. To do this, the TRV will now be opened and closed twice to store the end points.

SET UP

LifeSmart's **Thermostatic Radiator Valve** needs to be paired with Smart Station to join the smart system.

1. After configuration of the smart station, click "+" on the app home page, then click "**Add Device**", select "**Thermostatic Radiator Valve**", enter pairing mode.

2. Follow the instruction on the app to start pairing.

3. Wait a moment till connection done, then signal icon stop moving.

4. Press **ON/OFF** button to return, and press **ON/OFF** button again to turn it on.

5. If a time-out error occurs, please repeat step 1-4.

6. Thermostatic Radiator Valve has features such as timer set temperature and interaction with other smart devices. Please follow the instructions on the app to discover.

SET UP

Mode setting

Press **M** button to choose Manual mode/Away mode/PRG mode, or you can also do this in LifeSmart App.

Clock & Weekday setting

Press and hold **P** button for 5s, set the clock (Min-Hour-Weekday) by pressing **UP** and **DOWN** button, each press of **P** button will go to next item setting.

Open window detect function (OWD function)

When the Open Window mode is enabled in the parameter setting, the system will automatically stop heating when it detects a sudden drop of room temperature (2°C in 15 minutes as default). This is normally caused when a window or door is opened without turning off the heating device. The device will return to the previous mode of operation after 30mins, then **OP** disappear. Press any button will exit **OWD** function during the heating off period.

PROGRAMMABLE SCHEDULE

After finish the clock setting, press **P** to go to PRG schedule setting.

Set the schedule (Weekday-Period-Start time-Temp.) by pressing **UP** and **DOWN** button, each press of **P** button will go to next item setting.

You can also do this in LifeSmart App.

Default Setting:

Period	1		2		3		4	
	Time	Temp	Time	Temp	Time	Temp	Time	Temp
1(Mon.)	7:00	22°C	8:30	19°C	17:00	22°C	22:00	19°C
2(Tues.)	7:00	22°C	8:30	19°C	17:00	22°C	22:00	19°C
3(Wed.)	7:00	22°C	8:30	19°C	17:00	22°C	22:00	19°C
4(Thurs.)	7:00	22°C	8:30	19°C	17:00	22°C	22:00	19°C
5(Fri.)	7:00	22°C	8:30	19°C	17:00	22°C	22:00	19°C
6(Sat.)	8:00	22°C	8:30	22°C	17:00	22°C	22:00	19°C
7(Sun.)	8:00	22°C	8:30	22°C	17:00	22°C	22:00	19°C

PARAMETER SETTING

Turn off the TRV, press and hold **M** and **UP** button for 3s, until it shows the item 01, each press of **M** button will go to next item setting, adjust the range by using **UP** and **DOWN** button.

Menu	Description	Range	Default Value
1	Temp. calibration for internal sensor	-8 °C ~-8 °C	0°C
2	Set Point Max.	5 °C ~35°C	35 °C
3	Set Point Min.	5 °C ~-35°C	5 °C
4	Frost Protection Temp.	5 °C ~15°C	5 °C
5	Display	0: Room temp. 1: SET temp.	0
6	Open window detect function	1: ON 0: OFF	0
7	OWD Detect Time	2~30mins	15mins
8	OWD Drop temp. select (within detect time)	2/3/4°C	2°C
9	OWD Delay time select (Return to previous working status)	10~60min	30mins

PARAMETER SETTING

Menu	Description	Range	Default Value
10	Factory reset	0: No 1: Yes, and then press On/off button for 5s,wait until the rmostat restart	0
11	Software version	/	/
12	Software version	/	/
13	Battery voltage	Unit: 10mv	/
14	PID P-band select	2 °C ~10°C	7°C
15	PID I-time select	30~90min	30min

WARRANTY DESCRIPTION

Thank you for purchasing this LifeSmart product. In order to protect your rights, please read the following content carefully: The warranty period of our company's products is one year from the date of purchase or longer if local laws impose a longer minimum term, in which case the minimum term is the warranty period. During the warranty period, any faults caused by the product itself or for quality problems that arise under normal usage, LifeSmart will provide a free replacement.

User support e-mail address

support@ilifsmart.com

Website

www.ilifsmart.com



ATTENTION

TRVs do not control the boiler.

TRVs should be set at a level that gives you the room temperature you want. These settings may have to be different in each room, and you should set the TRV to suit each room and then leave them to do their job. Turning a TRV to a higher setting will not make the room heat up any faster. How quickly the room heats up depends on the boiler size and setting, and the radiator size. Turning a TRV to a lower setting will result in the room being controlled at a lower temperature, and saves energy. TRVs need a free flow of air to sense the temperature so they must not be covered by curtains or blocked by furniture.

ATTENTION

The following conditions are not covered by the warranty:

- Product failure or damage caused by installation, use, and maintenance that is not in accordance with the product instructions;
- Products beyond the warranty period;
- Products that have the barcode tampered with or removed;
- Devices that have been tampered with or customized outside of LifeSmart Terms Of Service as on the LifeSmart APP and website;
- User-caused damage, such as inappropriate voltage input, high temperature, accidental spillage, physical damage, etc;

DECLARATION

LifeSmart is a trademark of Hangzhou LifeSmart Technology Co., Ltd. As for the trademarks, product logos and product names from other companies presented within this manual, they are possessed by their own right holders. Without our written permission, no entity or individual shall extract, copy or disseminate in part or the whole of the manual contents in any form. Due to product version upgrades or other reasons, content of this manual may change. Our company reserves the right to change the contents of this manual without any notice. This manual is used only for instructional purposes. We strive to provide accurate information in this manual, but we are not able to ensure that the content of this manual is current. Statements, information and advice in this manual do not constitute any expressed or implied assurance. Updated manuals are available on our website at www.ilifesmart.com or by contacting our team.

 Facebook: [ilfesmarthome](#)  Twitter: [ilfesmarthome](#)

Copyright © 2020 LifeSmart Inc. All Rights Reserved.